



OPEN September 2021

FACILITY

- 4 stories, 68,000 square feet

INCLUDES

- 6 traditional lecture-style classrooms
- 6 active-learning classrooms
- 4 chemistry labs
- 2 biology labs
- environmental science lab
- geology/paleontology lab
- 2 faculty research labs (School of Earth & Environment)
- faculty offices (School of Earth & Environment)
- student collaboration space

COST OF PROJECT

\$46.7 million

ARCHITECT

KSS Architects

CONSTRUCTION MANAGEMENT

Terminal Construction

PROJECT DEVELOPER

Gloucester County Improvement Authority

PROJECT PLANNING AND DEVELOPMENT

Rowan Facilities, Planning & Operations

Introducing Discovery Hall

Anchoring the academic corridor from the east end of Rowan University's Glassboro campus, Discovery Hall expands facilities for the School of Earth & Environment and the College of Science & Mathematics. It supports Rowan's focus on high quality, affordable undergraduate education, as well as the University's growing research portfolio.

Configured to provide a holistic learning environment, the building features classrooms, teaching laboratories, research laboratories and conference rooms. With a four-story design for the building's west section and two stories for the east, the facility preserves open space for engaging landscaping, pedestrian and vehicular access and parking.

Discovery Hall's landscaping and permeable paving surfaces contribute to Rowan's plan for comprehensive stormwater management with native plants and recycled materials.

Focus on undergraduate research opportunities

With enrollment expanding, so does Rowan's support for students across disciplines, especially in high-demand STEM (Science, Technology, Engineering and Mathematics) fields. Rowan is the nation's fifth fastest-growing public research university, listed for the fourth consecutive year in the Chronicle of Higher Education's notable roster. As the institution earns recognition for its growing applied research portfolio and expands graduate programs in STEM, Discovery Hall is designed in large measure to support continued opportunities for undergraduate students in education and real-world research. Its six new science teaching labs provide space for active learning and collaboration between students and faculty. Biology and chemistry labs, built to accommodate a growing number of students in the College of Science & Mathematics, were designed for both lectures and wet lab benchwork.

Specialty areas for the School of Earth & Environment include labs dedicated to geology, paleontology, environmental science, computational research and a molecular paleontology lab, one of two research spaces in the nation dedicated to the study of ancient proteins in fossils.

FIRST FLOOR

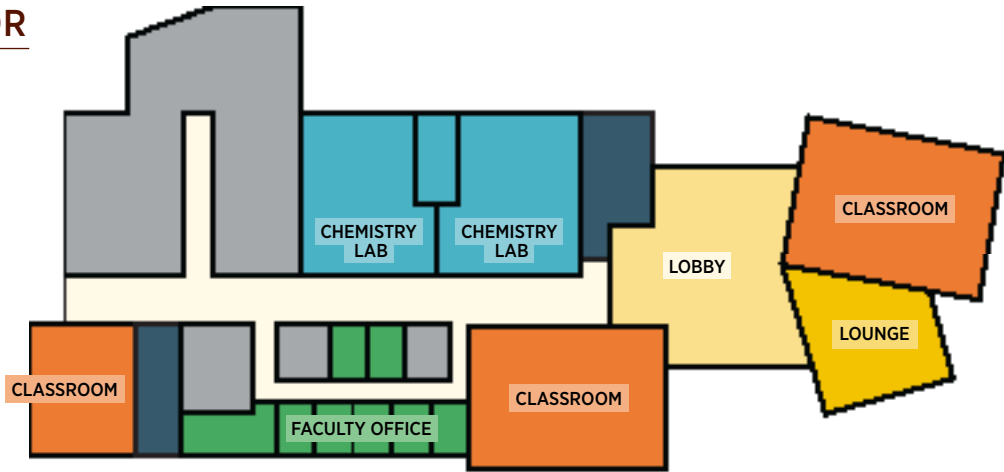

SECOND FLOOR

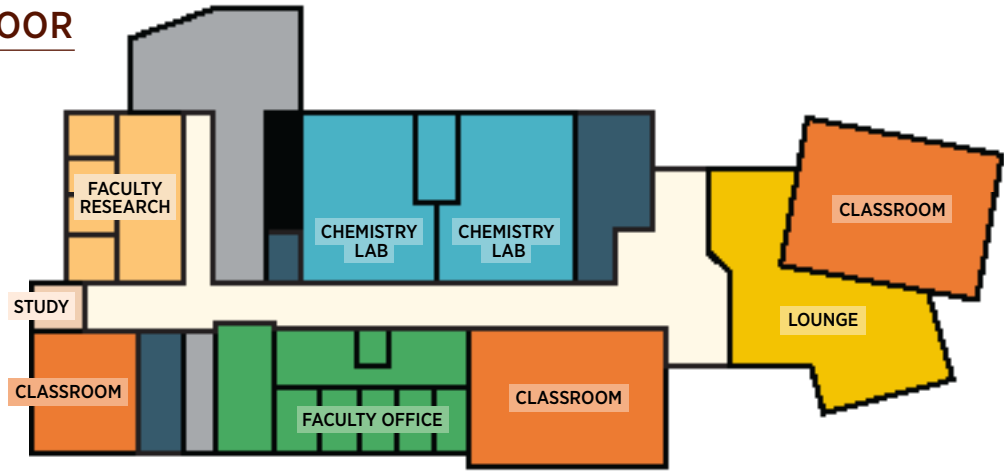

THIRD FLOOR

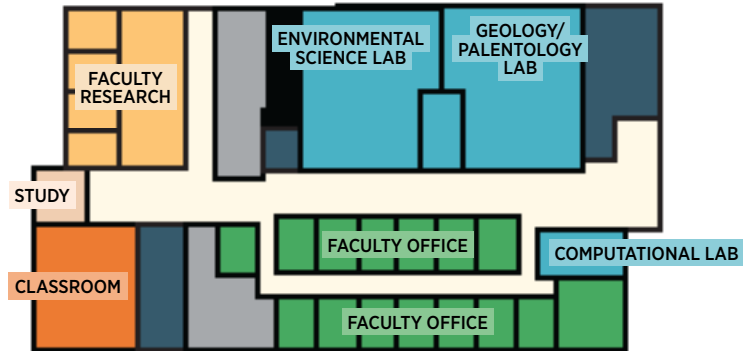

FOURTH FLOOR

